



ALLROUND FINDER

A circular badge with a thin gold border, containing the text "4G" in a gold, sans-serif font.

4G

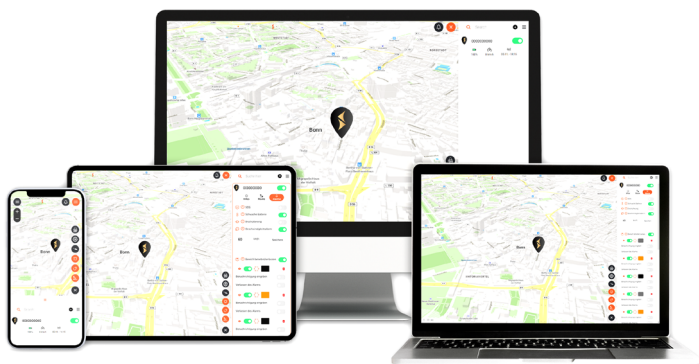

Table of contents



Thank you for purchasing our FINDER!

Before starting: Read the instructions carefully,
before using the FINDER for the first time. Please keep this user manual
in a safe place in case you may need it in the future.

2.1 Scope of delivery	24
2.2 Product description	25
2.3 Instructions for charging	25
2.4 Activation	26
2.5 Switch on/off	26
2.6 Use	27
2.7 Meaning of the LED lights	30
2.8 Operating the SOS button	31
2.9 Technical details	32
2.10 Safety instructions	33
2.11 Disposal of used batteries	38
2.12 Disposal of electrical devices.....	39

NOTE!

We update our user manuals on a regular basis, in order to keep them up to date. The latest version can be viewed at any time at www.paj-gps.de/finder.

2.1 Scope of delivery

Your delivery will include:

- ALLROUND Finder 4G
- charging cable
- USB wall plug
- protective case
- M2M SIM card*



*the M2M SIM card is already inside your
FINDER and is not replaceable

2.2 Product description



2.3 Instructions for charging

Before using the FINDER for the first time you must charge it. Connect the magnetic part of the charging cable to the FINDER's magnetic contact. Connect the USB connector to the wall-plug adapter and plug it into a power socket. If the FINDER is connected to the power source, it will switch on automatically. Please charge the FINDER until the red LED goes off.

NOTE!

The ALLROUND Finder 4G has a battery duration of approximately 20 days, needless of charging it in between! However, beware that this duration will depend on how much you use your device. The more the ALLROUND Finder 4G is in motion and thus sending data to the portal, the greater the battery usage.

2.4 Activation

In order to use your ALLROUND Finder 4G, you will need to previously activate it online. Enter the following link and follow the instructions:



2.5 Switch on/off

When activation is successful, turn on the GPS tracker by sliding the switch located under the protective rubber to the right. The LED lights then activate. To switch off, move the switch to the left.

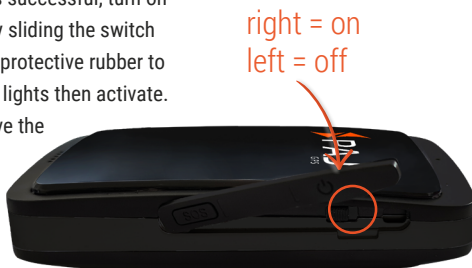

2.6 Use

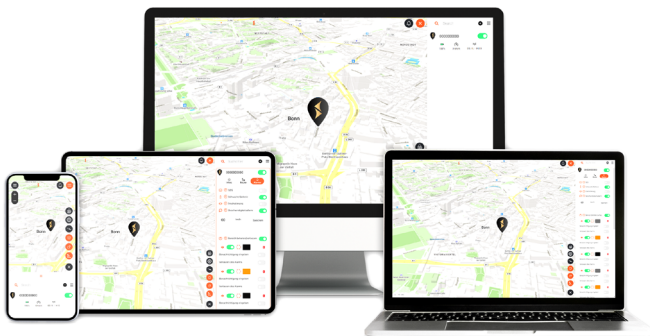

As soon as your device has been successfully activated, started up and has sent and logged data for the first time, you can place it wherever you choose and use your phone, tablet or PC to start tracking it! You will be able to do this in our App or enter the following link to the desktop version:

www.v2.finder-portal.com



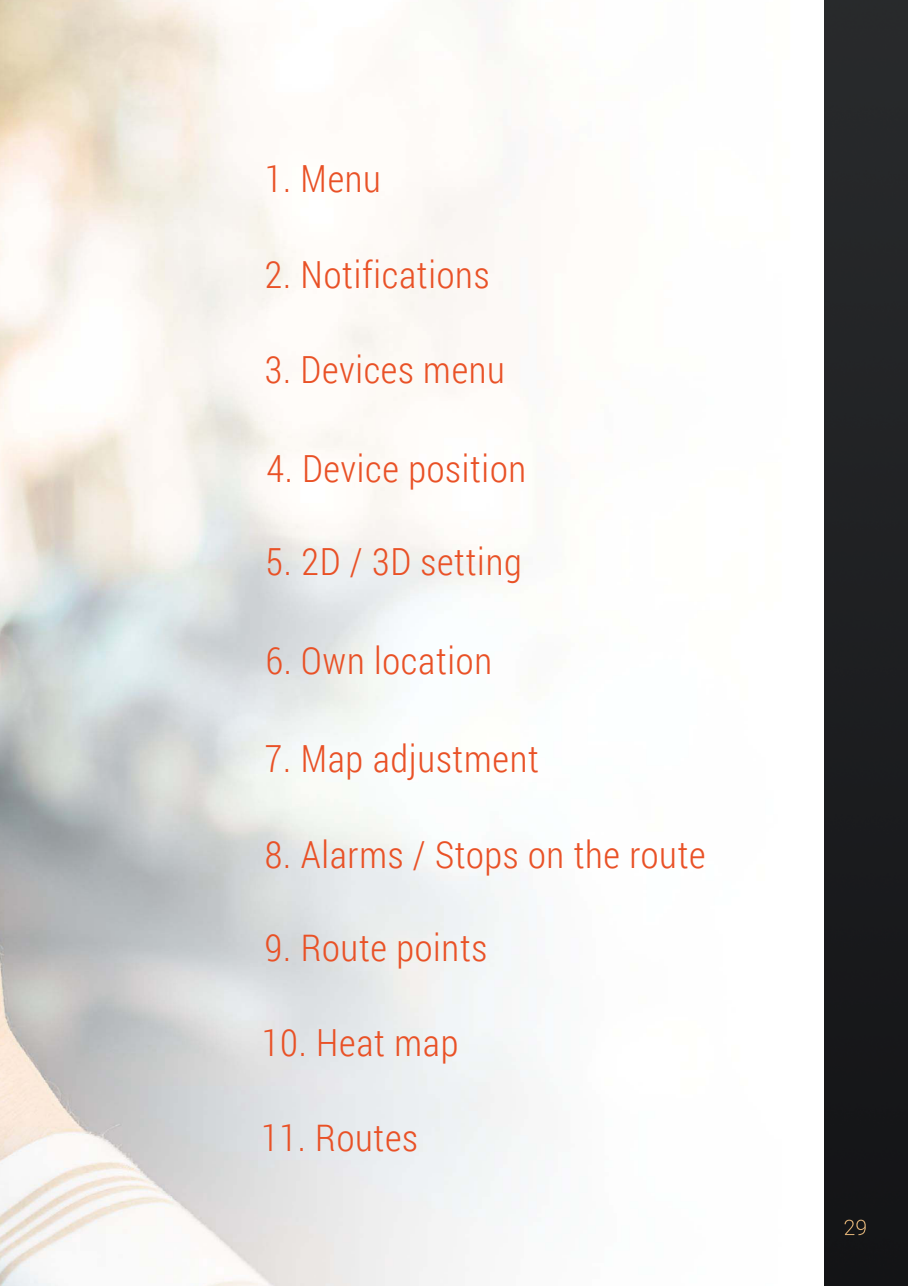

- 
1. Menu
 2. Notifications
 3. Devices menu
 4. Device position
 5. 2D / 3D setting
 6. Own location
 7. Map adjustment
 8. Alarms / Stops on the route
 9. Route points
 10. Heat map
 11. Routes

2.7 Meaning of the LED lights

Orange LED - GSM status



Signal

Meaning

The orange LED is blinking	There is no available GSM signal
----------------------------	----------------------------------

The orange LED is off	The GPS Tracker is in standby mode or switched off
-----------------------	--

The orange LED is fixed	A GSM signal is available
-------------------------	---------------------------

Blue LED - GPS status



Signal

Meaning

The blue LED is blinking	There is no available GPS signal
--------------------------	----------------------------------

The blue LED is off	The GPS Tracker is in standby mode or switched off
---------------------	--

The blue LED is fixed	A GPS signal is available
-----------------------	---------------------------

Red LED - battery status



Signal

Meaning

The red LED is off (when charging cable is plugged in)	The GPS Tracker is fully charged
---	----------------------------------

The red LED is fixed (when charging cable is plugged in)	The GPS Tracker is charging
---	-----------------------------



The LEDs flash alternately for 12 seconds

The SOS button has been pressed for 5 seconds and an SOS signal has been sent.

2.8 Operating the SOS button

Press and hold the SOS button for 5 seconds and the FINDER will send an alarm. You can see whether an alarm has been sent by the orange and blue LEDs flashing alternately for 12 seconds.



2.9 Technical Details

Dimensions	105,5 mm x 63 mm x 22,7 mm
GPS accuracy	under 10 meters
Standby time	approximately 60 days
Battery	3,7 V 5.000 mAh Li-ion
Weight	170 g
Start time	Cold start: 30 s Standby: 30 s / running: 1 s
Network	GSM/GPRS/EDGE/FDD-LTE/TDD-LTE
Bandwidth	LTE-FDD: B1/B2/B3/B4/B5/B7/B8/B12/B13/ B18/B19/B20/B25/B26/B28/B66/ LTE-TDD :B34/B38/B39/B40/B41 GSM/GPRS/EDGE: 850/900/1800/1900 MHz
GPS-Chip	AT6558R
GSM-/GPRS-Module	SIMCOM A7670G
GPS reception	-162 dBm
Charger	110-220 V, AC 50 Hz input 5 V/1A, DC output
Storage temperature	from -30 °C to +80 °C
Operating environment	from -20 °C to +75 °C
Humidity	10 %-85 %
Water protection	IP64

2.10 Safety Instructions

Signal words

The following signal words are used in these operating instructions:

NOTE!

This is a warning about possible damage to property.

WARNING!

This classifies a hazard of medium risk level. Failure to comply with the warning may result in serious injury.

Proper use

Please read the safety instructions for this PAJ FINDER, hereinafter only referred to as GPS tracker, carefully before use in order to be able to deploy it properly. The intended use is to employ the GPS tracker only as described in this manual to locate an object or a living being. Please bear in mind that it is a criminal offence to monitor third parties using a GPS tracker without their consent. If you use it in any other way, this is considered improper use and can lead to damage to property or even personal injury. Please note that the GPS tracker is not a toy for children.

In other countries and regions there are different laws on digital positioning and localization of people, animals and/or objects. PAJ UG is not responsible if such laws or regulations are violated, this is the sole responsibility of the user.

NOTE!

The manufacturer and dealer accept no liability for damage caused by improper or incorrect use.

Safety

WARNING! RISK OF ELECTRIC SHOCK!

A faulty electrical installation or a mains voltage that is too high can lead to an electric shock.

- Before use, make sure that the mains voltage of the socket corresponds with the information on the type plate.
- To be able to disconnect the charging cable from the mains as quickly as possible in the event of a failure, connect the power supply unit where it is easily accessible.
- If you notice any visible damage to your GPS tracker or charging cable, do not use it.
- Use only the original parts supplied to charge the GPS tracker. If the charging cable is damaged, replace it only with original accessories from the manufacturer.
- Never place the GPS tracker near an open fire or hot surfaces.
- The GPS tracker is not protected against humidity and water. Please use and store it only in a dry environment.
- The charging cable should only be used indoors. Keep it away from humidity and do not kink it.
- Do not open the housing of the GPS tracker. Leave the repair to qualified specialists. However, if you carry out repairs yourself, connect the GPS tracker incorrectly or operate it incorrectly, liability and warranty claims are excluded.

Hazards for children and vulnerable people

WARNING! DANGER OF SUFFOCATION!

Please do not let people (including children) with limited physical, sensory or mental abilities use the GPS tracker. It is considered an exception if they have previously received instructions from a person responsible for their safety on how to use the device. Please be sure that they not play with small parts (e.g. accessories, etc.). These may be swallowed, leading to suffocation.

NOTE!

Inform your child about the dangers and use of the GPS tracker.

The battery

WARNING! EXPLOSION AND FIRE HAZARD!

Below you will find information and instructions on how to use the battery:

- The GPS tracker runs by a lithium ions battery. It is not exchangeable and must not be removed or opened.
- Make sure that the GPS tracker (also when charging the battery) is kept away from heat sources and high temperatures, such as direct sunlight in a vehicle. Disregard of this instruction may result in destruction of the battery and overheating, explosion and fire.
- Only use the original accessories for the charging process. If the battery is charged otherwise, this may result in overheating, explosion or fire.
- Do not burn or pierce the GPS tracker. Protect it from mechanical damage.
- If a child swallows the battery, seek medical aid immediately!

Removing or replacing the battery

- Contact our support if the battery needs to be removed or replaced.
- Send the machine to us to remove or replace the battery.
- For safety reasons, do not attempt to remove the battery. Failure to remove the battery properly may result in damage to the battery and unit, personal injury and/or compromise the safety of the unit.
- PAJ GPS shall not be liable for any damage or loss (whether in contract or tort, including negligence) arising from your failure to comply with these warnings and instructions.

WARNING! RISK OF CHEMICAL BURNS!

Batteries that leak due to damage can cause burns if they come into contact with the skin. Therefore, never open the battery. However, if the battery leaks, please wear protective gloves.

Electromagnetic compatibility

Please observe all rules and prohibitions and switch off the GPS tracker immediately in danger areas and if it might cause interference. Furthermore, it should not be used in the vicinity of, for example, medical equipment, fuels and chemicals, or in blasting areas. With mobile devices, malfunction due to interference may occur and affect performance. Transformers and very strong magnetic fields must be avoided. Otherwise there may be deviations in the transmission.

NOTE!

Failure to observe these recommendations may result in malfunctions or damage to the GPS tracker.

Cleaning

WARNING! RISK OF DAMAGE!

Below you will find information and instructions on how to clean the GPS tracker:

- Do not use aggressive cleaning agents or brushes for cleaning. Do not clean the GPS tracker with metallic cleaning objects (e.g. knife, metal sponge). This may damage the surface.
- Never put the GPS tracker in water, in a dishwasher (or the like) and do not use a steam cleaner.

Correct cleaning:

- The surface may be wiped clean with a slightly dampened cloth.
- The GPS tracker should then be wiped dry completely.

Storage

If you are not using the GPS tracker for a lengthy period of time, turn it off. Place the tracker in its original packaging or in a carton of the same size. Protect the tracker from dirt and humidity.

NOTE!

Keep the FINDER away of children's reach in order to avoid possible damage to property or personal injury.

Declaration of conformity

Hereby, PAJ UG (haftungsbeschränkt) declares that the tracker, ALLROUND Finder 4G, is in conformity with the Directive 2014/53/EU. The complete text of the EU Declaration of Conformity can be found at the following Internet address: paj-gps.de/konformitaetserklaerung/



Packaging disposal

Dispose of the packaging according to type. Throw cardboard and paper to the corresponding container. Foil belongs in the recyclables collection.



2.11 Disposal of used batteries

The following note is addressed to those who use batteries or products with products with built-in batteries and who will not resell them in the form in which they were supplied to them (end users).

Free recall of used batteries.

Batteries must not be disposed of with waste. You are legally obliged to return used batteries so that proper disposal can be guaranteed. You can return used batteries to a local collection point or to your local retailer. As a distributor of batteries, we are also to take back used batteries, although our obligation to take back used is limited to the type which we carry or have carried as batteries in our range. Used batteries of the aforementioned type can therefore either be returned to us with sufficient postage or handed in directly to our dispatch warehouse at the following address free of charge:

PAJ UG (haftungsbeschränkt)
Hohe Straße 61
51570 Windeck
Germany
E-Mail: info@paj-gps.de

Meaning of the battery symbols

Batteries are marked with the symbol of a crossed-out dustbin (see illustration). This symbol indicates that batteries must not be disposed of in household waste. Batteries containing more than 0.0005% mercury by mass, more than 0.002% cadmium by mass or more than 0.004% lead by mass are also marked with the chemical name of the pollutant below the dustbin symbol. The abbreviation „Cd” stands for cadmium, „Pb” for lead and „Hg” for mercury.



2.12 Disposal of electrical devices

The Electrical and Electronic Equipment Act (ElektroG) contains a large number of requirements for the handling of electrical and electronic equipment. The most important ones are summarised here.

1. Separate collection of WEEE:

Waste Electrical and Electronic Equipment that has become waste is referred to as WEEE. Owners of WEEE must dispose of it separately from unsorted local waste. In particular, WEEE does not belong in household waste, but in special collection and return systems.

2. Batteries and accumulators:

As a rule, owners of WEEE must separate spent batteries and accumulators that are not enclosed in the WEEE before handing them over at a collection point. This does not apply if the WEEE is handed over to public waste management authorities and separated from other WEEE there for the purpose of preparation for reuse.

3. Options for returning old appliances (WEEE):

Owners of WEEE from private households can hand it in to public waste management authorities or at the collection points set up by manufacturers or distributors as defined by the ElektroG. An online directory of collection and collection points can be found here: <https://www.ear-system.de/ear-verzeichnis/sammel-und-ruecknahmestellen.jsf>

4. Data Protection:

Old equipment often contains sensitive personal data. This applies in particular to information and telecommunication technology devices such as computers and smartphones. For your own sake, please note that each end-user is responsible for deleting the data on the old equipment to be disposed of.

5. Meaning of the „crossed-out dustbin“ symbol:

The symbol of a crossed-out dustbin regularly displayed on electrical and electronic equipment indicates that the respective device must be separated from unsorted local waste at the end of its service life.



6. Manufacturer registration number

As a manufacturer, within the meaning of the ElektroG, we are registered with the responsible foundation Elektro-Altgeräte Register (Benno-Strauß-Str. 1, 90763 Fürth) under the following registration number: DE33887550.

DO YOU HAVE ANY QUESTIONS?



In this case, please contact us
and we will be delighted to help you!

PAJ UG (haftungsbeschränkt)
Hohe Straße 61
51570 Windeck
Germany

Mail: info@paj-gps.de
Telefon: +49 (0) 2292 39 499 59
Web: www.paj-gps.de

The PAJ GPS Team
wishes you to enjoy your ALLROUND Finder 4G!



PAJ UG (haftungsbeschränkt)
Hohe Straße 61, 51570 Windeck
Germany